

MIDDLE BAY

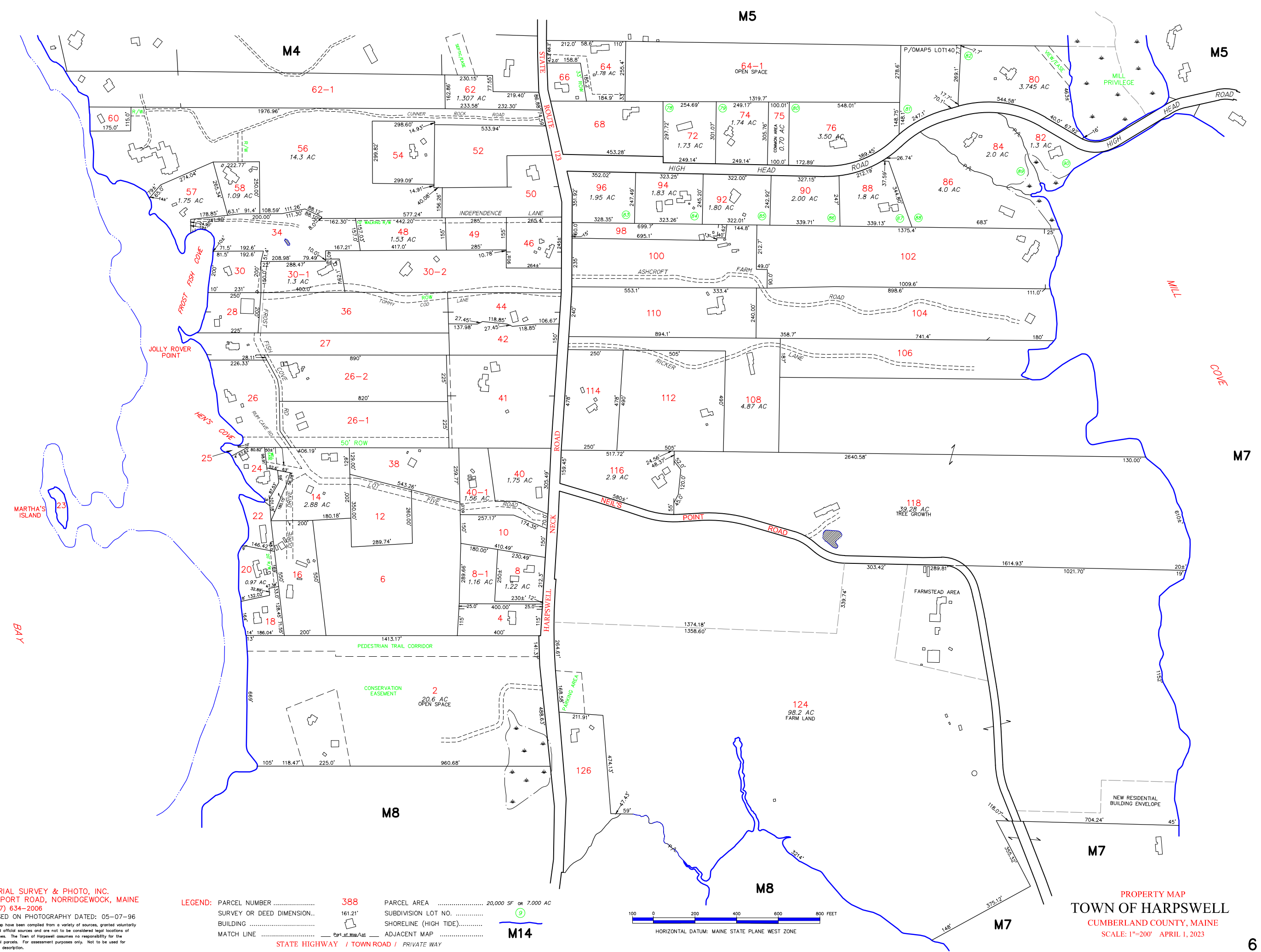

PREPARED BY: AERIAL SURVEY & PHOTO, INC.
 AIRPORT ROAD, NORRIDGEWOCK, MAINE
 (207) 634-2006
 BASED ON PHOTOGRAPHY DATED: 05-07-96

NOTE: The data on this map have been compiled from a variety of sources, granted voluntarily by private owner and official sources and are not to be considered legal locations of property boundary lines. The Town of Harpswell assumes no responsibility for the accuracy of individual parcels. For assessment purposes only. Not to be used for conveyances or legal description.

BLDGs UPDATED TO APRIL 2023

LEGEND:

PARCEL NUMBER	388	PARCEL AREA	20,000 SF or 7,000 AC
SURVEY OR DEED DIMENSION	161.21'	SUBDIVISION LOT NO.	9
BUILDING		SHORELINE (HIGH TIDE)	
MATCH LINE		ADJACENT MAP	M14

STATE HIGHWAY / TOWN ROAD / PRIVATE WAY

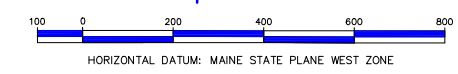

HORIZONTAL DATUM: MAINE STATE PLANE WEST ZONE

PROPERTY MAP
 TOWN OF HARPSWELL
 CUMBERLAND COUNTY, MAINE
 SCALE: 1"=200' APRIL 1, 2023