

BASIN POINT  
**M17**

POTTS

HARBOR

POTTS POINT  
**M19**

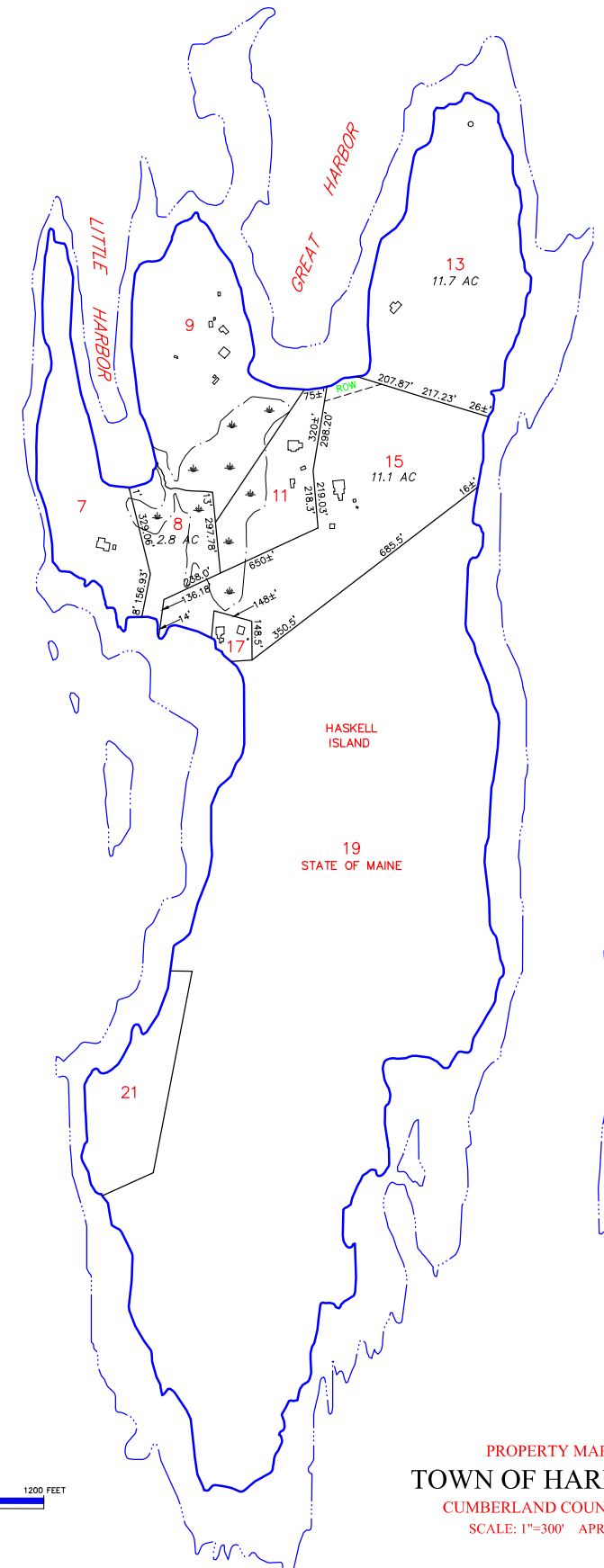
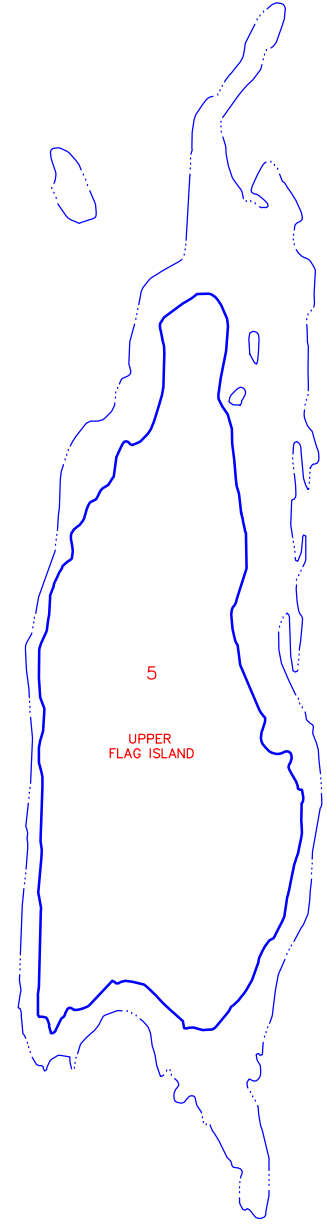
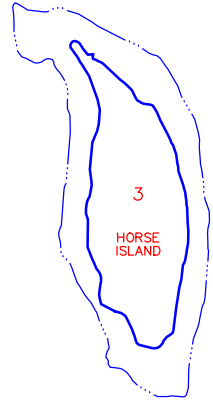
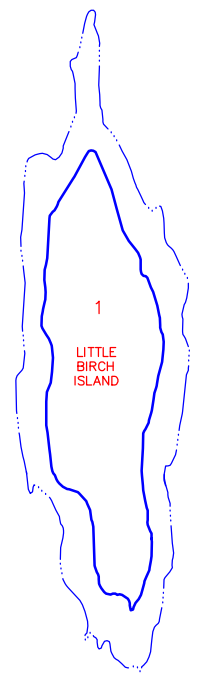

BROAD

SOUND

MERRICONEAG

SOUND

HASKELL ISLAND  
19  
STATE OF MAINE



PREPARED BY: AERIAL SURVEY & PHOTO, INC.  
AIRPORT ROAD, NORRIDGEWOCK, MAINE  
(207) 634-2006  
BASED ON PHOTOGRAPHY DATED: 05-07-96  
NOTE: The data on this map have been compiled from a variety of sources, granted voluntarily by private owner and official sources and are not to be considered legal locations of property boundary lines. The Town of Harpswell assumes no responsibility for the accuracy of individual parcels. For assessment purposes only. Not to be used for conveyances or legal description.

LEGEND:	PARCEL NUMBER .....	<b>388</b>	PARCEL AREA .....	20,000 SF or 7,000 AC
	SURVEY OR DEED DIMENSION..	161.21'	SUBDIVISION LOT NO. ....	<b>9</b>
	BUILDING .....		SHORELINE (HIGH TIDE) .....	
	MATCH LINE .....		ADJACENT MAP .....	<b>M14</b>
		Part of Map/lot		
		STATE HIGHWAY / TOWN ROAD / PRIVATE WAY		

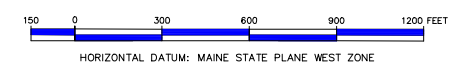

PROPERTY MAP  
**TOWN OF HARPSWELL**  
CUMBERLAND COUNTY, MAINE  
SCALE: 1"=300' APRIL 1, 2023